

brunner ::

# A-Bench

Benchmark.



OFFICE/CONFERENCE | PUBLIC SPACES | CARE

---

SEATING | TABLES | OCCASIONAL FURNITURE

Meinema | De Meubelmakelaar | 0031 - 20 311 8396



# A-Bench



- Modular system and thus suitable for a wide variety of uses, e.g. cafeteria, restaurant, co-working space and lounge
- High-quality moulded foam upholstery elements with pocket-sprung and cut foam inserts for outstanding seating comfort
- Choose from various linear linking mechanisms, either in rows or at 90° angles, or in a curve, also available with alternating seat direction
- Legs available in die-cast aluminium or optional solid oak wood
- Virtually invisible cross beams make the seat elements appear to float

OFFICE / CONFERENCE | PUBLIC SPACES | CARE

SEATING | TABLES | OCCASIONAL FURNITURE

brunner ::

# A-Bench

/ LOUNGE SEATING SYSTEM

Designer: jehs+laub

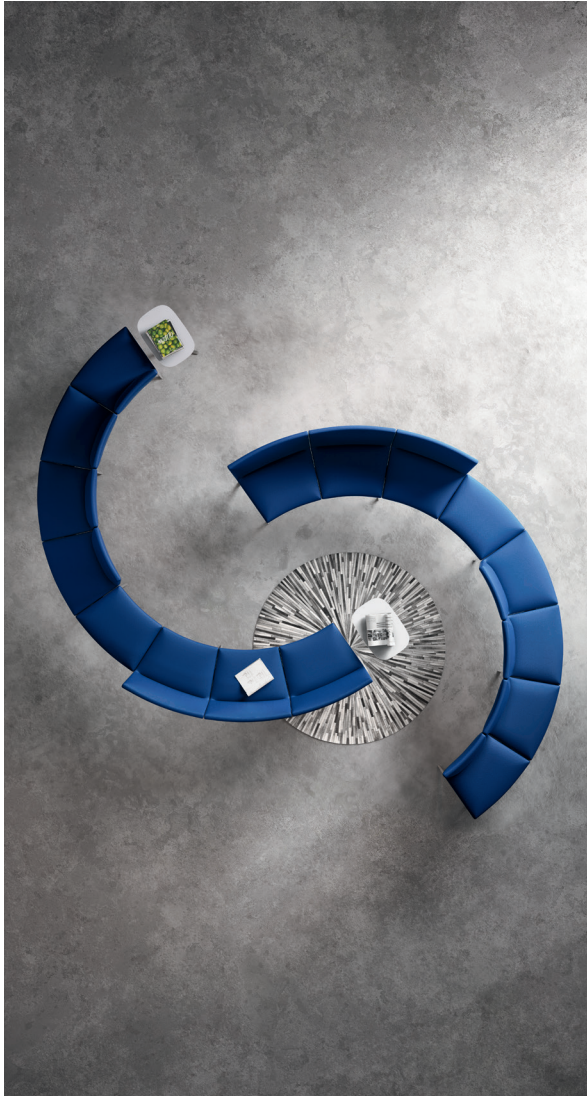



# A-Bench

/ LOUNGE SEATING SYSTEM

Designer: jehs+laub

<b>model no.</b>	<b>9791-200</b> (die-cast aluminium) <b>9792-200</b> (solid oak wood)	<b>9791-201</b> (die-cast aluminium) <b>9792-201</b> (solid oak wood)
<b>basic model</b>	<ul style="list-style-type: none"> <li>– 2-seater bench   2 x seat cushion</li> <li>– 2-seater bench   2 x seat</li> <li>– V-shaped foot stirrup</li> <li>– foot stirrup screwed to the traverse</li> <li>– fully upholstered seating elements with a grid dimension of 65 cm, available in various finishes</li> <li>– set onto the traverse in aluminium-line-press-profiles and screwed with four fittings made of impact resistant polyamide</li> <li>– traverse in aluminium, coated in lava RAL 7021 FS matt</li> <li>– <b>die-cast aluminium:</b> V-shaped foot stirrup in die-cast aluminium, polished, plastic gliders, anti-sliding</li> <li>– <b>solid oak wood:</b> V-shaped foot stirrup in solid oak wood, stained according to oak standard range, matt lacquered, gliders with QuickClick-System (15)</li> </ul>	
<b>dimensions</b>		
<b>weight</b>	25,0 kg 23,0 kg	35,0 kg 33,0 kg
<b>options / accessories</b>	<ul style="list-style-type: none"> <li>– foot stirrup coated in lava RAL 7021 FS matt or white RAL 9016 FS matt (available for traverse in aluminium)</li> <li>– foot stirrup chromed (available for traverse in aluminium)</li> <li>– <b>die-cast aluminium:</b> gliders (3)</li> <li>– <b>solid oak wood:</b> gliders with QuickClick-System (16)</li> <li>– writing tablet (ST 979), swivelling, can be mounted between two upholstered elements, flat steel bars coated lava RAL 7021 FS matt or white RAL 9016 FS matt, solid core top, black or white, d = 38 cm</li> <li>– electrification box (E 100), screwed under a cushion element, aluminium housing, coated lava RAL 7021 FS matt, accessible from two sides, can be equipped with 2x power or 1x power and 1x USB-A double charger. Please specify the desired equipment when ordering. Incl. supply cable 3 m, available for D; CH; F; UK</li> </ul>	
<b>upholstery</b>	fabric / leather according to Brunner standard range (including artificial leather)	
<b>colours</b>	stain colours according to Brunner standard range	
coating colours	<div style="display: inline-block; width: 20px; height: 15px; background-color: black; margin-right: 5px;"></div> <b>lava</b> RAL 7021 FS matt	<div style="display: inline-block; width: 20px; height: 15px; background-color: white; margin-right: 5px;"></div> <b>white</b> RAL 9016 FS matt
surface	chromed	

# A-Bench

/ LOUNGE SEATING SYSTEM

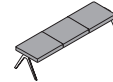
Designer: jehs+laub

<b>model no.</b>	<b>9791-202</b> (die-cast aluminium) <b>9792-202</b> (solid oak wood)	<b>9791-300</b> (die-cast aluminium) <b>9792-300</b> (solid oak wood)
<b>basic model</b>	– 2-seater bench   1 x seat with integrated arm right, 1 x seat with integrated arm left	– 3-seater bench   3 x seat cushion
<b>basic model</b>	<ul style="list-style-type: none"> <li>– V-shaped foot stirrup</li> <li>– foot stirrup screwed to the traverse</li> <li>– fully upholstered seating elements with a grid dimension of 65 cm, available in various finishes</li> <li>– set onto the traverse in aluminium-line-press-profiles and screwed with four fittings made of impact resistant polyamide</li> <li>– traverse in aluminium, coated in lava RAL 7021 FS matt</li> <li>– <b>die-cast aluminium:</b> V-shaped foot stirrup in die-cast aluminium, polished, plastic gliders, anti-sliding</li> <li>– <b>solid oak wood:</b> V-shaped foot stirrup in solid oak wood, stained according to oak standard range, matt lacquered, gliders with QuickClick-System (15)</li> </ul>	
<b>dimensions</b>		
<b>weight</b>	43,0 kg 41,0 kg	34,5 kg 32,5 kg
<b>options / accessories</b>	<ul style="list-style-type: none"> <li>– foot stirrup coated in lava RAL 7021 FS matt or white RAL 9016 FS matt (available for traverse in aluminium)</li> <li>– foot stirrup chromed (available for traverse in aluminium)</li> <li>– <b>die-cast aluminium:</b> gliders (3)</li> <li>– <b>solid oak wood:</b> gliders with QuickClick-System (16)</li> <li>– writing tablet (ST 979), swivelling, can be mounted between two upholstered elements, flat steel bars coated lava RAL 7021 FS matt or white RAL 9016 FS matt, solid core top, black or white, d = 38 cm</li> <li>– electrification box (E 100), screwed under a cushion element, aluminium housing, coated lava RAL 7021 FS matt, accessible from two sides, can be equipped with 2x power or 1x power and 1x USB-A double charger. Please specify the desired equipment when ordering. Incl. supply cable 3 m, available for D; CH; F; UK</li> </ul>	
<b>upholstery</b>	fabric / leather according to Brunner standard range (including artificial leather)	
<b>colours</b>	stain colours according to Brunner standard range	
coating colours	<b>lava</b> RAL 7021 FS matt <b>white</b> RAL 9016 FS matt	
surface	chromed	

# A-Bench

/ LOUNGE SEATING SYSTEM

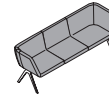
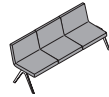
Designer: jehs+laub

<b>model no.</b>	<b>9791-301</b> (die-cast aluminium) <b>9792-301</b> (solid oak wood)	<b>9791-302</b> (die-cast aluminium) <b>9792-302</b> (solid oak wood)
<b>basic model</b>	– 3-seater bench   3 x seat	– 3-seater bench   1 x seat with integrated arm right, 1 x seat, 1 x seat with integrated arm left
	<ul style="list-style-type: none"> <li>– V-shaped foot stirrup</li> <li>– foot stirrup screwed to the traverse</li> <li>– fully upholstered seating elements with a grid dimension of 65 cm, available in various finishes</li> <li>– set onto the traverse in aluminium-line-press-profiles and screwed with four fittings made of impact resistant polyamide</li> <li>– traverse in aluminium, coated in lava RAL 7021 FS matt</li> <li>– <b>die-cast aluminium:</b> V-shaped foot stirrup in die-cast aluminium, polished, plastic gliders, anti-sliding</li> <li>– <b>solid oak wood:</b> V-shaped foot stirrup in solid oak wood, stained according to oak standard range, matt lacquered, gliders with QuickClick-System (15)</li> </ul>	
<b>dimensions</b>		
<b>weight</b>	49,5 kg 47,5 kg	57,5 kg 55,5 kg
<b>options / accessories</b>	<ul style="list-style-type: none"> <li>– foot stirrup coated in lava RAL 7021 FS matt or white RAL 9016 FS matt (available for traverse in aluminium)</li> <li>– foot stirrup chromed (available for traverse in aluminium)</li> <li>– <b>die-cast aluminium:</b> gliders (3)</li> <li>– <b>solid oak wood:</b> gliders with QuickClick-System (16)</li> <li>– writing tablet (ST 979), swivelling, can be mounted between two upholstered elements, flat steel bars coated lava RAL 7021 FS matt or white RAL 9016 FS matt, solid core top, black or white, d = 38 cm</li> <li>– electrification box (E 100), screwed under a cushion element, aluminium housing, coated lava RAL 7021 FS matt, accessible from two sides, can be equipped with 2x power or 1x power and 1x USB-A double charger. Please specify the desired equipment when ordering. Incl. supply cable 3 m, available for D; CH; F; UK</li> </ul>	
<b>upholstery</b>	fabric / leather according to Brunner standard range (including artificial leather)	
<b>colours</b>	stain colours according to Brunner standard range	
	coating colours	<div style="display: flex; align-items: center; gap: 10px;"> <div style="background-color: black; width: 20px; height: 10px; display: inline-block;"></div> <b>lava</b> RAL 7021 FS matt           <div style="background-color: white; width: 20px; height: 10px; display: inline-block; border: 1px solid black;"></div> <b>white</b> RAL 9016 FS matt         </div>
	surface	<div style="display: flex; align-items: center; gap: 10px;"> <div style="background-color: #cccccc; width: 50px; height: 15px; display: inline-block;"></div> chromed         </div>

# A-Bench

/ LOUNGE SEATING SYSTEM

Designer: jehs+laub

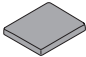
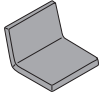
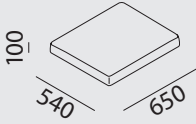
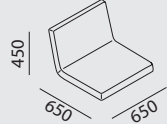
		
model no.	9790-KG	9790-SG
<b>basic model</b>	– seat cushion straight	– seat straight
	– fully upholstered seating elements with a grid dimension of 65 cm, available in various finishes, freely combinable – individual elements set onto the traverse in aluminium-line-press-profiles and screwed with four fittings made of impact resistant polyamide – for configuration of a straight, radius or corner shaped bench	
<b>dimensions</b>		
<b>weight</b>	7,0 kg	12,0 kg
<b>upholstery</b> fabric / leather	according to Brunner standard range (including artificial leather)	

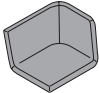
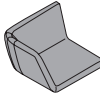
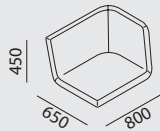
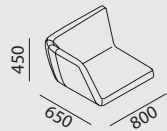
		
model no.	9790-SAR	9790-SAL
<b>basic model</b>	– seat with integrated arm right	– seat with integrated arm left
	– fully upholstered seating elements with a grid dimension of 65 cm, available in various finishes, freely combinable – individual elements set onto the traverse in aluminium-line-press-profiles and screwed with four fittings made of impact resistant polyamide – for configuration of a straight, radius or corner shaped bench	
<b>dimensions</b>		
<b>weight</b>	16,0 kg	16,0 kg
<b>upholstery</b> fabric / leather	according to Brunner standard range (including artificial leather)	

# A-Bench

/ LOUNGE SEATING SYSTEM

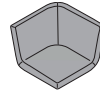
Designer: jehs+laub

<b>model no.</b>	<b>9790-SE</b>
<b>basic model</b>	<ul style="list-style-type: none"> <li>– corner 90°</li> <li>– fully upholstered seating elements with a grid dimension of 65 cm, available in various finishes, freely combinable</li> <li>– individual elements set onto the traverse in aluminium-line-press-profiles and screwed with four fittings made of impact resistant polyamide</li> <li>– for configuration of a straight, radius or corner shaped bench</li> </ul>
<b>dimensions</b>	
<b>weight</b>	16,0 kg
<b>upholstery</b> fabric / leather	according to Brunner standard range (including artificial leather)

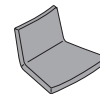
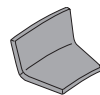

	<b>9790-SRI</b>	<b>9790-SRA</b>
<b>model no.</b>	<b>9790-SRI</b>	<b>9790-SRA</b>
<b>basic model</b>	<ul style="list-style-type: none"> <li>– seat with inner radius 22,5°</li> </ul>	<ul style="list-style-type: none"> <li>– seat with outer radius 22,5°</li> </ul>
	<ul style="list-style-type: none"> <li>– fully upholstered seating elements with a grid dimension of 65 cm, available in various finishes, freely combinable</li> <li>– individual elements set onto the traverse in aluminium-line-press-profiles and screwed with four fittings made of impact resistant polyamide</li> <li>– for configuration of a straight, radius or corner shaped bench</li> </ul>	
<b>dimensions</b>		
<b>weight</b>	13,0 kg	12,0 kg
<b>upholstery</b> fabric / leather	according to Brunner standard range (including artificial leather)	



# A-Bench

/ LOUNGE SEATING SYSTEM

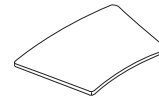
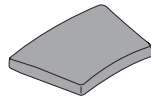
Designer: jehs+laub

	9790-KR	9790-T03
<b>model no.</b>	9790-KR	9790-T03
<b>basic model</b>	<ul style="list-style-type: none"> <li>– seat cushion suitable for inner and outer radius 22,5°</li> </ul>	<ul style="list-style-type: none"> <li>– tablet instead of a seating element</li> </ul>
	<ul style="list-style-type: none"> <li>– individual elements set onto the traverse in aluminium-line-press-profiles and screwed with four fittings made of impact resistant polyamide</li> <li>– for configuration of a straight, radius or corner shaped bench</li> </ul>	
	<ul style="list-style-type: none"> <li>– fully upholstered seating elements with a grid dimension of 65 cm, available in various finishes, freely combinable</li> </ul>	<ul style="list-style-type: none"> <li>– tablet in MDF material, edge with corner radius R20 mm, table top thickness 20 mm, HPL according to standard range, ABS Flow 20 (available in the colours black, white, off-white, light grey)</li> </ul>
<b>dimensions</b>		
<b>weight</b>	7,0 kg	6,5 kg
<b>options / accessories</b>	<ul style="list-style-type: none"> <li>– NTB according to standard range, ABS Flow 20 to match the surface</li> <li>– oak veneer stained according to oak standard range, matt lacquered, BK Flow 20 edge to match the surface</li> </ul>	
<b>upholstery</b>	according to Brunner standard range (including artificial leather)	
fabric / leather		
	9790-T01	9790-T02
<b>model no.</b>	9790-T01	9790-T02
<b>basic model</b>	<ul style="list-style-type: none"> <li>– tablet instead of a seating element, straight configuration</li> </ul>	<ul style="list-style-type: none"> <li>– tablet instead of a seating element, corner configuration</li> </ul>
	<ul style="list-style-type: none"> <li>– tablet in MDF material, edge with corner radius R20 mm, table top thickness 20 mm, HPL according to standard range, ABS Flow 20 (available in the colours black, white, off-white, light grey)</li> <li>– individual elements set onto the traverse in aluminium-line-press-profiles and screwed with four fittings made of impact resistant polyamide</li> </ul>	
<b>dimensions</b>		
<b>weight</b>	5,5 kg	6,0 kg
<b>options / accessories</b>	<ul style="list-style-type: none"> <li>– NTB according to standard range, ABS Flow 20 to match the surface</li> <li>– oak veneer stained according to oak standard range, matt lacquered, BK Flow 20 edge to match the surface</li> </ul>	

# A-Bench

/ LOUNGE SEATING SYSTEM

Designer: jehs+laub

<b>model no.</b>	<b>9790-FAL1</b> (die-cast aluminium) <b>9790-FE11</b> (solid oak wood)	<b>9790-FAL2</b> (die-cast aluminium) <b>9790-FE12</b> (solid oak wood)
<b>basic model</b>	<ul style="list-style-type: none"> <li>– V-shaped foot stirrup</li> <li>– foot stirrup as connecting element of two traverses or as end of a configuration, screwed to the traverse</li> <li>– <b>die-cast aluminium:</b> V-shaped foot stirrup in die-cast aluminium, polished, plastic gliders, anti-sliding</li> <li>– <b>solid oak wood:</b> V-shaped foot stirrup in solid oak wood, stained according to oak standard range, matt lacquered, gliders with QuickClick-System (15)</li> </ul>	
<b>weight</b>	3,0 kg 2,0 kg	4,7 kg 2,5 kg
<b>options / accessories</b>	<ul style="list-style-type: none"> <li>– foot stirrup coated in lava RAL 7021 FS matt or white RAL 9016 FS matt (available for traverse in aluminium)</li> <li>– foot stirrup chromed (available for traverse in aluminium)</li> <li>– <b>die-cast aluminium:</b> gliders (3)</li> <li>– <b>solid oak wood:</b> gliders with QuickClick-System (16)</li> </ul>	
<b>upholstery</b>	fabric / leather according to Brunner standard range (including artificial leather)	
<b>colours</b>	stain colours according to Brunner standard range	
coating colours	<div style="display: inline-block; width: 20px; height: 10px; background-color: black; margin-right: 5px;"></div> <b>lava</b> RAL 7021 FS matt	<div style="display: inline-block; width: 20px; height: 10px; background-color: white; margin-right: 5px;"></div> <b>white</b> RAL 9016 FS matt
surface	chromed	

# A-Bench

/ LOUNGE SEATING SYSTEM

Designer: jehs+laub

	9790-TR2	9790-TR3
<b>model no.</b>	9790-TR2	9790-TR3
<b>basic model</b>	- 2-seater traverse	- 3-seater traverse
	- traverse in aluminium, coated in lava RAL 7021 FS matt	
<b>weight</b>	5,0 kg	7,5 kg
<b>colours</b>	lava RAL 7021 FS matt	
coating colours		

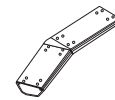
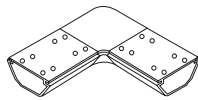

	9790-TRE	9790-TRS
<b>model no.</b>	9790-TRE	9790-TRS
<b>basic model</b>	- corner traverse	- radius traverse for two seating elements (suitable for inner and outer radius)
	- traverse in aluminium, coated in lava RAL 7021 FS matt	
<b>weight</b>	2,5 kg	3,5 kg
<b>colours</b>	lava RAL 7021 FS matt	
coating colours		

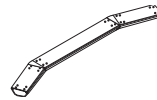

	9790-TRR
<b>model no.</b>	9790-TRR
<b>basic model</b>	- radius traverse for two seating elements (suitable for inner and outer radius)
	- Combination of just two radius elements: you need 2 end foot stirrups, 1 connecting foot stirrup and 2 radius traverses 9790-TRS.
	- traverse in aluminium, coated in lava RAL 7021 FS matt
<b>weight</b>	7,0 kg
<b>colours</b>	lava RAL 7021 FS matt
coating colours	